

3. 35 GA Concentric Ring Valve Assembly - Model 71T2

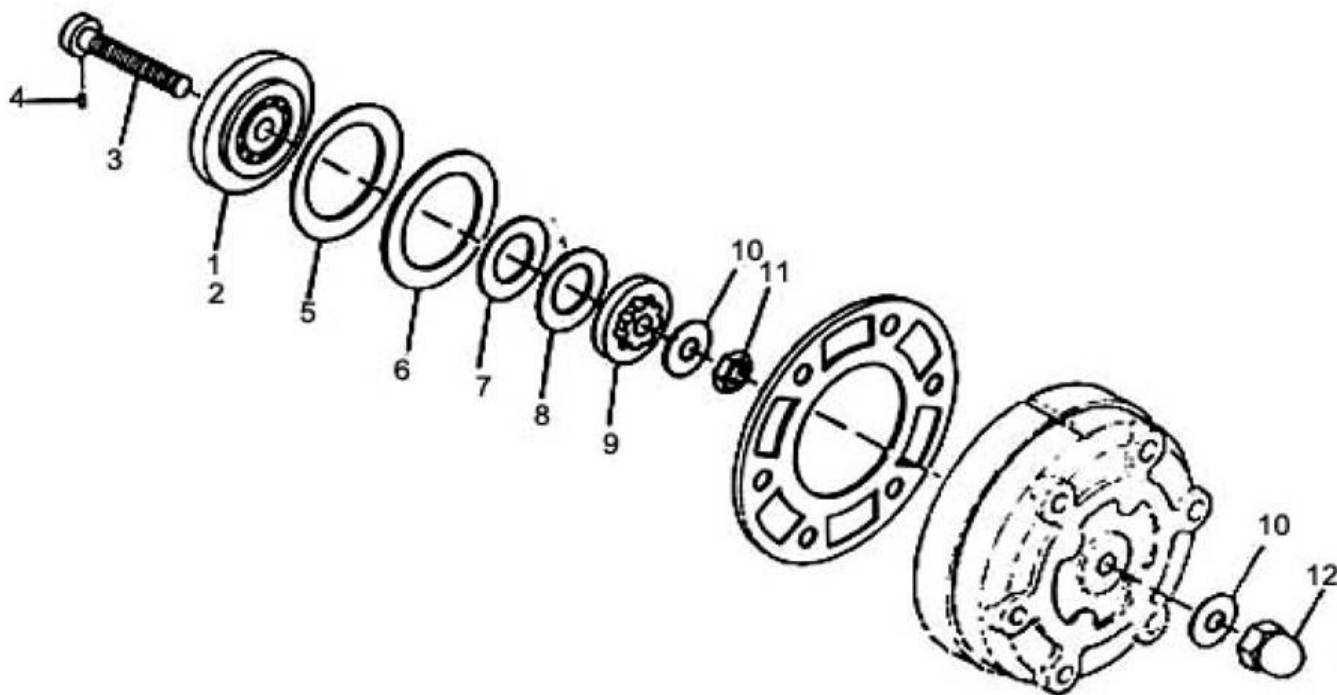

All manufacturer's names, numbers, photos, product description and/or part numbers are used for reference purposes only & it is not implied that any part listed is the product of these manufacturers. Since Approvement are made from time to time, the illustration and specifications are subject to change without notice.

3. 35 GA Concentric Ring Valve Assembly - Model 71T2

REF. NO.	PART NUMBER	DESCRIPTION	CCN NUMBER	UNITS PER ASSY	REC SPARES		
					1	2	3
3-1	W75300T30X	Valve complete	37004827	1			
3-2	W21449	* Seat discharge valve	30217608	1			
3-3	W21454	* Bolt valve	30220925	1			
3-4	W34171	** Pin bolt	37002656	1			
3-5	W21448	* Spring inlet valve	30221501	1	1	1	1
3-6	W21447	* Plate inlet valve	30181499	1	1	1	1
3-7	W21451	* Plate discharge valve	30215941	1	1	1	1
3-8	W21452	* spring discharge valve	30221576	1	1	1	1
3-9	W21450	* Plate discharge valve stop	30218994	1			
3-10	W114141T63	* Washer spring belleville	37092913	2			2
3-11	22A4C7	* Nut hex	95076808	1			
3-12	W21750	* Nut acorn	30287643	1			

All manufacturer's names, numbers, photos, product description and/or part numbers are used for reference purposes only & it is not implied that any part listed is the product of these manufacturers. Since Approvement are made from time to time, the illustration and specifications are subject to change without notice.